



## Daleside Road , Pudsey, LS28 8HA

- 3 spacious bedrooms
- Cosy lounge area
- Lovely garden space
- Located on Daleside Road
- Easy access to transport
- Modern kitchen finishes
- Separate dining room
- Built in 1950 charm
- Close to local amenities
- Viewing highly recommended



Local Authority  
Council Tax Band **B**  
EPC Rating **E**



## Floorplan



**Ground Floor**

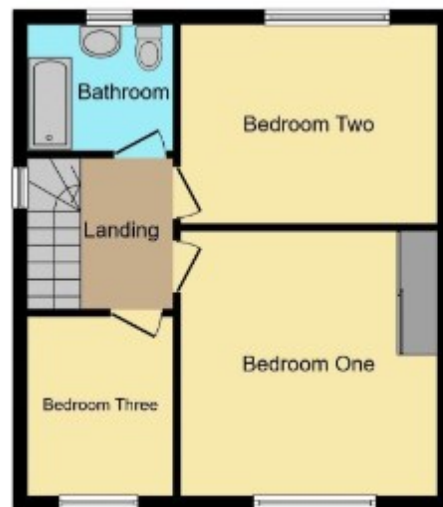

**First Floor**

This floor plan is for illustrative purposes only. It is not drawn to scale. Any measurements, floor areas (including any total floor area), openings and orientation are approximate. No details are guaranteed, they cannot be relied upon for any purpose and they do not form part of any agreement. No liability is taken for any error, omission or misstatement. A buyer must rely upon its own inspection/s. Plan produced for GetAnOffer. Powered by [www.localagent.com](http://www.localagent.com)

### Smartsale4u Office

Suite 331 Kemp House, 152-160 City  
Road, London, EC1V 2NX

### Contact

0204 572 9091  
[info@smartsale4u.co.uk](mailto:info@smartsale4u.co.uk)  
[smartsale4u.co.uk](http://smartsale4u.co.uk)

Agents Note: Whilst every care has been taken to prepare these particulars, they are for guidance purposes only. All measurements are approximate and for general guidance purposes only and whilst every care has been taken to ensure accuracy, they should not be relied upon and potential buyers/tenants are advised to recheck the measurements.